

CERTIFIED LAND CORNER RECORDATION

DESCRIPTION OF CORNER EVIDENCE FOUND, AND ORIGINAL RECORD (if known)

LOCATION
S.11 S.12
S.14 S.13
T.14N., R.66W.
6th P.M.

Found a 1" x 1" oak hub and 3" x 6" x 4" piece of sandstone with one groove. Hub position accepted as section corner.

DESCRIPTION OF MONUMENT AND ACCESSORIES ESTABLISHED TO PERPETUATE THE ORIGINAL LOCATION OF THIS CORNER:

At the corner: Set a 1½" dia. x 30" long iron pipe with brass cap.
Accessories: None

SKETCH, WITH COURSE AND DISTANCE TO ADJACENT CORNER IF DETERMINED IN THIS SURVEY.
(May Sketch or Paste Reproduction on Reverse Side.)

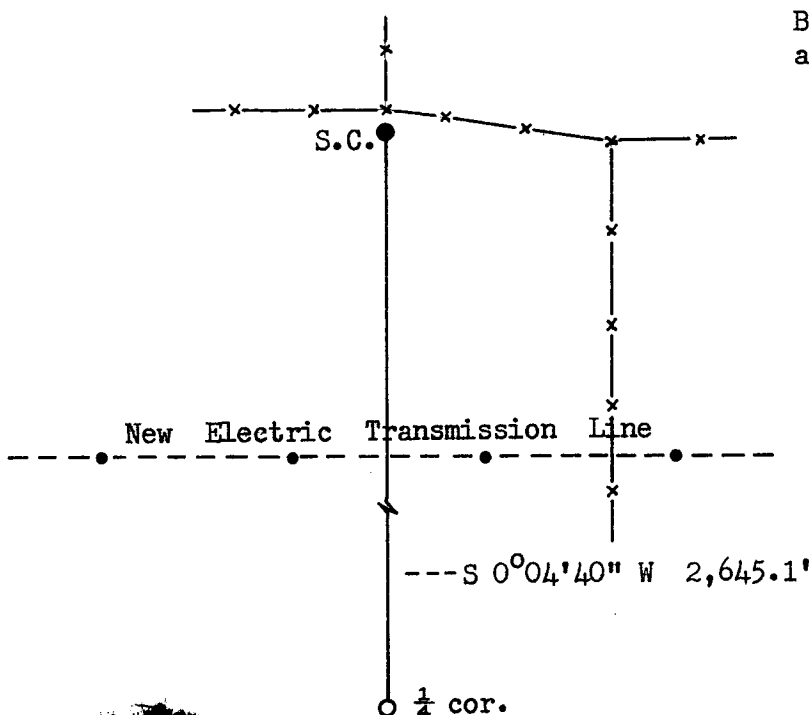

Basis of Bearing - By solar observation at the ¼ cor. common to Secs. 14 & 15.

Brass cap set 4" above ground.

Brass cap stamped:

T.14N. R.66W.
S.C.
S.11 S.12
S.14 S.13
LS 519 1973

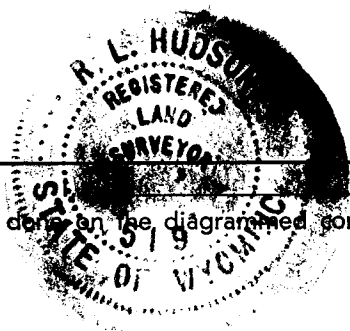

R.L. Hudson certify that I have carefully performed or reviewed the work done on the diagrammed corner as reported on this recordation form and approve the same.

R.L. Hudson
Signature of Surveyor

Wyoming L.S. No. 519
Registration No.

STATE OF WYOMING,
Office of Clerk and Recorder,
County of Taramie

This "corner record" was filed for record on the 29th day of May, 19 73, was noted on the cross-index plat and is assigned page No 14-66, in book No. ONE.

Jolly B. Williams
County Official

Cross Index No. _____	T. _____	R. _____	Mer. _____
_____	T. _____	R. _____	Mer. _____
_____	T. _____	R. _____	Mer. _____
_____	T. _____	R. _____	Mer. _____
_____	T. _____	R. _____	Mer. _____
_____	T. _____	R. _____	Mer. _____
_____	T. _____	R. _____	Mer. _____

289687

Photographed _____
Indexed ✓
Posted MA

The State of Wyoming }
County of Laramie } SS

This instrument was filed for record
at 9:54 o'clock A.M. on the
29 day of May
A. D. 19 23 and duly recorded in
Book on page

John B. Spillman

County Clerk & Ex-Officio Register of Deeds
By John B. Spillman Deputy